

### 尖峰抑制线圈

### RADIAL LEADED FIXED INDUCTORS

Operating Temp: -20°C ~ 85°C



#### 特征:

- 低损耗.
- 广泛应用.
- 安装空间小.
- YKPK0406 类型具有优良特性的品质系数.
- 其他类型 DCR 小,大电流,最好的电力供应线
- UL 管涵盖.
- 磁带包装自动插入.

#### FEATURES:

- Low cost.
- Wide range of inductance
- Small mounting space required.
- YKPK0406 type with excellent characteristics for high Q.
- The other types with low DCR, large current, best for the power supply line.
- Covered with UL tube.
- Tape packaging for automatic insertion.

#### 用途:

- 电视和音响设备.
- 通信设备.
- 开关电源.
- 噪声滤波器.

#### APPLICATIONS:

- TVs and Audio equipment.
- Telecommunication devices.
- Switching Power Supply.
- Other noise filter.

#### 产品型号:

#### PRODUCT IDENTIFICATION:

**YKPK** — **0608** — **503** — **K** — **UL** — **TF**

①	②	③	④	⑤	⑥										
①	②	③	④	⑤	⑥										
<table border="1"> <tr><th colspan="2">类型 Type</th></tr> <tr><td>YKPK</td><td>尖峰抑制线圈 Radial Leaded Fixed Inductors</td></tr> </table>		类型 Type		YKPK	尖峰抑制线圈 Radial Leaded Fixed Inductors	<table border="1"> <tr><th colspan="2">外形尺寸(L×H) (mm) External Dimensions (L×H) (mm)</th></tr> <tr><td>0608</td><td>11.0X2.5</td></tr> </table>		外形尺寸(L×H) (mm) External Dimensions (L×H) (mm)		0608	11.0X2.5	<table border="1"> <tr><th>Inductance</th></tr> <tr><td>50 mH</td></tr> </table>		Inductance	50 mH
类型 Type															
YKPK	尖峰抑制线圈 Radial Leaded Fixed Inductors														
外形尺寸(L×H) (mm) External Dimensions (L×H) (mm)															
0608	11.0X2.5														
Inductance															
50 mH															
<table border="1"> <tr><th>Tolerance</th></tr> <tr><td>J:±5%,K: ±10%, L: ±15% M: ±20%,P: ±25%, N: ±30%</td></tr> </table>		Tolerance	J:±5%,K: ±10%, L: ±15% M: ±20%,P: ±25%, N: ±30%	<table border="1"> <tr><th colspan="2">Sieve</th></tr> <tr><td>UL</td><td>Black UL125°C Tube</td></tr> <tr><td>no code</td><td>No sleeve</td></tr> </table>		Sieve		UL	Black UL125°C Tube	no code	No sleeve	<table border="1"> <tr><th>Taping Mode</th></tr> <tr><td>TF:taping; No code:bulk</td></tr> </table>		Taping Mode	TF:taping; No code:bulk
Tolerance															
J:±5%,K: ±10%, L: ±15% M: ±20%,P: ±25%, N: ±30%															
Sieve															
UL	Black UL125°C Tube														
no code	No sleeve														
Taping Mode															
TF:taping; No code:bulk															

#### Shape and Size(Dimension are in mm):

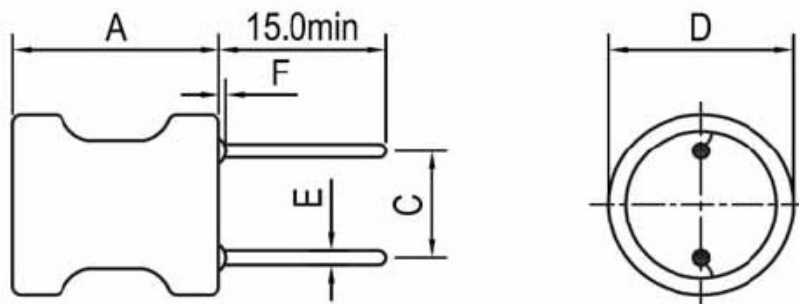

YK P/N	A max	C	D max	E±0.05	YK P/N	A max	C	D max	E±0.05
PK0406	8.0	2.0±0.5	5.0	0.55	PK1010	13.0	5.0±1.0	12.0	0.80
PK0608	11.0	2.5±0.5	7.0	0.65	PK1012	15.0	6.0±1.0	12.0	0.80
PK0707	9.5	5.0±1.0	8.0	0.65	PK1018	21.0	6.0±1.0	12.0	0.80
PK0807	9.5	5.0±1.0	9.0	0.65	PK1213	16.0	7.5±1.0	14.0	0.80
PK0810	13.0	5.0±1.0	9.0	0.65					

**YKPK0406 Series**

Part No.	L @1KHz (uH)	Q Min	Q Test Freq.	SRF (MHz) Min	DCR. (Ohm) Max	Rated Current (mA) Max
PK0406-1R0M-□□	1.0	100	7.96MHZ	120	0.035	2000
PK0406-1R2M-□□	1.2	100	7.96MHZ	120	0.058	1950
PK0406-1R5M-□□	1.5	100	7.96MHZ	120	<b>0.075</b>	1900
PK0406-1R8M-□□	1.8	100	7.96MHZ	120	0.110	1800
PK0406-2R2M-□□	2.2	100	7.96MHZ	100	0.120	1750
PK0406-2R7M-□□	2.7	100	7.96MHZ	80	0.125	1680
PK0406-3R3M-□□	3.3	100	7.96MHZ	75	0.130	1500
PK0406-3R9K-□□	3.9	100	7.96MHZ	70	0.135	1450
PK0406-4R7K-□□	4.7	100	7.96MHZ	50	0.140	1320
PK0406-5R6K-□□	5.6	100	7.96MHZ	45	0.145	1230
PK0406-6R8K-□□	6.8	100	7.96MHZ	30	0.15	1150
PK0406-8R2K-□□	8.2	100	7.96MHZ	22	0.16	1100
PK0406-100K-□□	10	80	2.52MHZ	20	0.23	1000
PK0406-120K-□□	12	80	2.52MHZ	17	0.24	970
PK0406-150K-□□	15	80	2.52MHZ	16	0.25	920
PK0406-180K-□□	18	80	2.52MHZ	12	0.33	860
PK0406-220K-□□	22	80	2.52MHZ	10	0.45	800
PK0406-270K-□□	27	80	2.52MHZ	9.5	0.50	710
PK0406-330K-□□	33	80	2.52MHZ	8.7	0.70	660
PK0406-390K-□□	39	70	2.52MHZ	8.2	0.74	600
PK0406-470K-□□	47	70	2.52MHZ	7.8	0.76	550
PK0406-560K-□□	56	50	2.52MHZ	7.6	0.80	500
PK0406-680K-□□	68	50	2.52MHZ	6.8	0.90	470
PK0406-820K-□□	82	50	2.52MHZ	6.0	0.95	430
PK0406-101K-□□	100	45	796KHZ	6.0	1.0	400
PK0406-121K-□□	120	45	796KHZ	5.5	1.1	370
PK0406-151K-□□	150	65	796KHZ	4.2	1.3	350
PK0406-181K-□□	180	65	796KHZ	3.6	1.5	320

PK0406-221K-□□	220	65	796KHZ	28	1.8	300
PK0406-271K-□□	270	50	796KHZ	24	1.9	275
PK0406-331K-□□	330	50	796KHZ	22	2.2	250
PK0406-391K-□□	390	50	796KHZ	20	2.7	220
PK0406-471K-□□	470	50	796KHZ	1.7	3.6	200
PK0406-561K-□□	560	50	796KHZ	1.5	4.2	190
PK0406-681K-□□	680	50	796KHZ	1.3	4.6	170
PK0406-821K-□□	820	50	796KHZ	1.1	5.7	155
PK0406-102K-□□	1000	90	252KHZ	1.0	6.7	150
PK0406-122K-□□	1200	90	252KHZ	0.9	8.2	140
PK0406-152K-□□	1500	80	252KHZ	0.8	13	120
PK0406-182K-□□	1800	80	252KHZ	0.8	15	110
PK0406-222K-□□	2200	80	252KHZ	0.8	17	100
PK0406-272K-□□	2700	80	252KHZ	0.8	19	90
PK0406-332K-□□	3300	70	252KHZ	0.7	26	83
PK0406-392K-□□	3900	70	252KHZ	0.65	30	76
PK0406-472K-□□	4700	65	252KHZ		45	70
PK0406-562K-□□	5600	65	252KHZ		48	62
PK0406-682K-□□	6800	65	252KHZ		56	56
PK0406-822K-□□	8200	65	252KHZ		62	52
PK0406-103K-□□	10000	45	79.6KHZ		72	47
PK0406-153K-□□	15000	45	79.6KHZ		120	35
PK0406-223K-□□	22000	45	79.6KHZ		160	24
PK0406-253K-□□	25000	45	79.6KHZ		180	20

### YKPK0608 Series

Part No.	L @1KHz (uH)	Q Min	Q Test Freq.	DCR. (Ohm) Max	Rated Current (mA) Max
PK0608-3R3K-□□	3.3	20	7.96MHZ	0.16	3500
PK0608-4R7K-□□	4.7	20	7.96MHZ	0.020	3000
PK0608-6R8K-□□	6.8	20	7.96MHZ	<b>0.022</b>	2500
PK0608-100K-□□	10	30	2.52MHZ	0.039	2000
PK0608-150K-□□	15	30	2.52MHZ	0.045	1700
PK0608-220K-□□	22	30	2.52MHZ	0.062	1400
PK0608-330K-□□	33	30	2.52MHZ	0.10	1100
PK0608-470K-□□	47	30	2.52MHZ	0.15	950
PK0608-680K-□□	68	30	2.52MHZ	0.22	800
PK0608-101K-□□	100	20	796KHZ	0.35	650
PK0608-151K-□□	150	20	796KHZ	0.43	540
PK0608-221K-□□	220	20	796KHZ	0.90	440

PK0608-331K-□□	330	20	796KHZ	1.50	350
PK0608-471K-□□	470	20	796KHZ	1.80	300
PK0608-681K-□□	680	20	796KHZ	2.5	250
PK0608-102-□□	1000	100	252KHZ	3.2	200
PK0608-122K-□□	1200	70	252KHZ	3.5	180
PK0608-152K-□□	1500	70	252KHZ	4.5	170
PK0608-182K-□□	1800	70	252KHZ	5.0	155
PK0608-222K-□□	2200	70	252KHZ	6.8	140
PK0608-272K-□□	2700	70	252KHZ	7.2	125
PK0608-332K-□□	3300	70	252KHZ	10.5	115
PK0608-392K-□□	3900	70	252KHZ	11.7	105
PK0608-472K-□□	4700	70	252KHZ	13.6	95
PK0608-562K-□□	5600	70	252KHZ	16.6	85
PK0608-682K-□□	6800	70	252KHZ	19.6	80
PK0608-822K-□□	8200	70	252KHZ	25.2	70
PK0608-103K-□□	10000	70	79.6KHZ	29.5	65
PK0608-123K-□□	12000	50	79.6KHZ	33.8	60
PK0608-153K-□□	15000	50	79.6KHZ	45.4	55
PK0608-183K-□□	18000	50	79.6KHZ	50.4	50
PK0608-223K-□□	22000	50	79.6KHZ	80.0	45
PK0608-303K-□□	30000	50	79.6KHZ	91.5	40
PK0608-333K-□□	33000	50	79.6KHZ	98.5	35
PK0608-393K-□□	39000	50	79.6KHZ	140	32
PK0608-473K-□□	47000	50	79.6KHZ	160	30
PK0608-503K-□□	50000	50	79.6KHZ	170	29
PK0608-563K-□□	56000	50	79.6KHZ	250	28
PK0608-683K-□□	68000	50	79.6KHZ	282	25
PK0608-823K-□□	82000	50	79.6KHZ	312	23
PK0608-104K-□□	100000	30	25.2KHZ	380	20
PK0608-124K-□□	120000	30	25.2KHZ	430	18
PK0608-154K-□□	150000	30	25.2KHZ	520	16

### YKPK0707Series

Part No.	L @1KHz (uH)	Q Min	Q Test Freq.	SRF (MHz) Min	DCR. (Ohm) Max	Rated Current (mA) Max	
						I Sat	I rms
YKPK0707-1R0M-□□	1.0	10	7.96MHz	70	0.006	6.6	5.0
YKPK0707-1R5M-□□	1.5	10	7.96MHz	56	0.008	5.4	4.3
YKPK0707-2R2M-□□	2.2	10	7.96MHz	45	0.011	4.0	3.7
YKPK0707-3R3M-□□	3.3	10	7.96MHz	35	0.018	3.6	2.9
YKPK0707-4R7M-□□	4.7	10	7.96MHz	29	0.022	3.1	2.6

YKPK0707-6R8M-□□	6.8	10	7.96MHz	24	0.028	2.5	2.3
YKPK0707-100K-□□	10	20	2.52MHz	19	0.043	2.1	1.9
YKPK0707-150K-□□	15	20	2.52MHz	15	0.056	1.7	1.6
YKPK0707-220K-□□	22	20	2.52MHz	12	0.086	1.4	1.3
YKPK0707-330K-□□	33	20	2.52MHz	9.4	0.14	1.1	1.0
YKPK0707-470K-□□	47	20	2.52MHz	7.6	0.17	0.96	0.94
YKPK0707-680K-□□	68	20	2.52MHz	6.2	0.28	0.79	0.73
YKPK0707-101K-□□	100	20	7.96MHz	5.0	0.33	0.66	0.67
YKPK0707-151K-□□	150	20	7.96MHz	4.0	0.56	0.53	0.52
YKPK0707-221K-□□	220	20	7.96MHz	3.2	0.72	0.44	0.46
YKPK0707-331K-□□	330	20	7.96MHz	2.5	1.10	0.36	0.37
YKPK0707-471K-□□	470	20	7.96MHz	2.0	1.70	0.30	0.30
YKPK0707-681K-□□	680	20	7.96MHz	1.7	2.30	0.25	0.26
YKPK0707-102K-□□	1000	70	2.52MHz	1.3	4.30	0.20	0.19
YKPK0707-152K-□□	1500	50	2.52MHz	1.3	5.00	0.17	0.16

### YKPK0807Series

Part No.	L @1KHz (uH)	Q Min	Q Test Freq.	SRF (MHz) Min	DCR. (Ohm) Max	Rated Current (mA) Max	
						I Sat	I rms
YKPK0807-2R2M-□□	2.2	10	7.96MHz	60	0.011	5.5	4.0
YKPK0807-3R3M-□□	3.3	10	7.96MHz	38	0.013	3.8	3.4
YKPK0807-4R7M-□□	4.7	10	7.96MHz	30	0.017	3.7	3.0
YKPK0807-6R8M-□□	6.8	10	7.96MHz	24	0.023	2.8	2.6
YKPK0807-100K-□□	10	20	2.52MHz	19	0.031	2.5	2.2
YKPK0807-150K-□□	15	20	2.52MHz	15	0.042	2.0	1.9
YKPK0807-220K-□□	22	20	2.52MHz	12	0.070	1.6	1.5
YKPK0807-330K-□□	33	20	2.52MHz	10	0.092	1.3	1.2
YKPK0807-470K-□□	47	20	2.52MHz	8.2	0.130	1.1	1.0
YKPK0807-680K-□□	68	20	2.52MHz	6.6	0.160	0.91	0.97
YKPK0807-101K-□□	100	15	796KHz	5.4	0.230	0.75	0.81
YKPK0807-151K-□□	150	15	796KHz	4.3	0.400	0.61	0.61
YKPK0807-221K-□□	220	15	796KHz	3.5	0.530	0.50	0.53
YKPK0807-331K-□□	330	15	796KHz	2.8	0.780	0.41	0.44
YKPK0807-471K-□□	470	10	796KHz	2.3	1.0	0.34	0.39
YKPK0807-681K-□□	680	10	796KHz	1.9	1.5	0.28	0.32
YKPK0807-102K-□□	1000	20	252KHz	1.5	2.2	0.23	0.26
YKPK0807-152K-□□	1500	30	252KHz	1.2	3.5	0.18	0.21

Part No.	L @1KHz (uH)	Q Min	Q Test Freq.	SRF (MHz) Min	DCR. (Ohm) Max	Rated Current (mA) Max
YKPK0810-3R3M-□□	3.3	30	7.96MHz	65	0.012	5000
YKPK0810-3R9K-□□	3.9	30	7.96MHz	55	0.014	4600
YKPK0810-4R7K-□□	4.7	30	7.96MHz	45	<b>0.016</b>	4300
YKPK0810-5R6K-□□	5.6	30	7.96MHz	38	0.020	3900
YKPK0810-6R8K-□□	6.8	30	7.96MHz	27	0.022	3700
YKPK0810-8R2K-□□	8.2	30	7.96MHz	21	0.024	3500
YKPK0810-100K-□□	10	50	2.52MHz	17	0.025	3200
YKPK0810-120K-□□	12	50	2.52MHz	15	0.027	3000
YKPK0810-150K-□□	15	50	2.52MHz	13	0.033	2800
YKPK0810-180K-□□	18	50	2.52MHz	12	0.039	2600
YKPK0810-220K-□□	22	50	2.52MHz	11	0.047	2400
YKPK0810-270K-□□	27	50	2.52MHz	10	0.052	2100
YKPK0810-330K-□□	33	50	2.52MHz	80.5	0.075	1900
YKPK0810-390K-□□	39	40	2.52MHz	7.7	0.082	1700
YKPK0810-470K-□□	47	40	2.52MHz	6.7	0.10	1500
YKPK0810-560K-□□	56	40	2.52MHz	6.4	0.15	1300
YKPK0810-680K-□□	68	30	2.52MHz	5.8	0.18	1200
YKPK0810-820K-□□	82	30	2.52MHz	5.2	0.20	1100
YKPK0810-101K-□□	100	30	796KHz	4.4	0.20	900
YKPK0810-121K-□□	120	30	796KHz	4.2	0.22	800
YKPK0810-151K-□□	150	30	796KHz	3.7	0.24	720
YKPK0810-181K-□□	180	30	796KHz	3.5	0.28	650
YKPK0810-221K-□□	220	20	796KHz	3.3	0.35	600
YKPK0810-271K-□□	270	20	796KHz	2.9	0.40	550
YKPK0810-331K-□□	330	20	796KHz	2.6	0.47	500
YKPK0810-391K-□□	390	20	796KHz	2.4	0.68	460
YKPK0810-471K-□□	470	20	796KHz	2.2	0.80	420
YKPK0810-561K-□□	560	20	796KHz	2.0	1.0	380
YKPK0810-681K-□□	680	20	796KHz	1.8	1.2	350
YKPK0810-821K-□□	820	20	796KHz	1.7	1.5	310
YKPK0810-102K-□□	1000	40	252KHz	1.5	1.8	280
YKPK0810-122K-□□	1200	40	252KHz	1.4	2.0	250
YKPK0810-152K-□□	1500	40	252KHz	1.3	2.4	230
YKPK0810-182K-□□	1800	40	252KHz	1.1	2.8	210
YKPK0810-222K-□□	2200	40	252KHz	1	3.3	190
YKPK0810-272K-□□	2700	40	252KHz	0.88	5.0	170
YKPK0810-332K-□□	3300	40	252KHz	0.78	5.6	150

YKPK0810-392K-□□	3900	40	252KHz	0.72	6.2	140
YKPK0810-472K-□□	4700	40	252KHz	0.65	7.0	130
YKPK0810-562K-□□	5600	40	252KHz	0.58	9.1	120
YKPK0810-682K-□□	6800	40	252KHz	0.55	10	110
YKPK0810-822K-□□	8200	20	252KHz	0.5	15	100
YKPK0810-103K-□□	10000	20	79.6KHz	0.42	24	90
YKPK0810-473K-□□	47000	60	79.6KHz	0.2	80	40
YKPK0810-104K-□□	100000	20	79.6KHz	0.14	180	28

### YKPK1010Series

Part No.	L @1KHz (uH)	Q Min	Q Test Freq.	SRF (MHz) Min	DCR. (Ohm) Max	Rated Current (mA) Max	
						I Sat	I rms
YKPK1010-3R3M-□□	3.3	10	7.96MHz	36	0.010	8.8	5.9
YKPK1010-4R7M-□□	4.7	10	7.96MHz	28	0.015	7.2	4.8
YKPK1010-6R8M-□□	6.8	10	7.96MHz	18	0.016	6.7	4.6
YKPK1010-100M-□□	10	20	2.52MHz	16	0.025	5.0	3.7
YKPK1010-150M-□□	15	20	2.52MHz	12	0.029	4.2	3.4
YKPK1010-200M-□□	22	20	2.52MHz	9.5	0.040	3.4	2.9
YKPK1010-330M-□□	33	20	2.52MHz	7.0	0.062	2.8	3.3
YKPK1010-470M-□□	47	20	2.52MHz	5.8	0.075	2.3	2.1
YKPK1010-680M-□□	68	20	2.52MHz	4.7	0.13	1.9	1.6
YKPK1010-101K-□□	100	20	796KHz	3.8	0.16	1.6	1.4
YKPK1010-151K-□□	150	20	796KHz	3.1	0.26	1.3	1.1
YKPK1010-221K-□□	220	20	796KHz	2.5	0.33	1.1	1.0
YKPK1010-331K-□□	330	20	796KHz	2.0	0.52	0.88	0.82
YKPK1010-471K-□□	470	10	796KHz	1.6	0.66	0.75	0.72
YKPK1010-681K-□□	680	10	796KHz	1.3	1.1	0.61	0.56
YKPK1010-102K-□□	1000	20	252KHz	1.1	1.4	0.51	0.50
YKPK1010-152K-□□	1500	30	252KHz	0.82	2.4	0.43	0.38
YKPK1010-222K-□□	2200	20	252KHz	0.76	3.2	0.35	0.33
YKPK1010-332K-□□	3300	30	252KHz	0.64	4.9	0.28	0.26
YKPK1010-472K-□□	4700	30	252KHz	0.54	7.6	0.24	0.21
YKPK1010-682K-□□	6800	30	252KHz	0.45	9.8	0.20	0.18
YKPK1010-103K-□□	10000	30	79.6KHz	0.38	18	0.17	0.14
YKPK1010-153K-□□	15000	50	79.6KHz	0.29	24	0.13	0.12

Part No.	L @1KHz (uH)	Q Min	Q Test Freq.	SRF (MHz) Min	DCR. (Ohm) Max	Rated Current (mA) Max	
						I Sat	I rms
YKPK1012-103K-□□	10000	100	79.6KHz	0.35	12	0.18	0.17
YKPK1012-123K-□□	12000	100	79.6KHz	0.31	13	0.16	0.16
YKPK1012-153K-□□	15000	100	79.6KHz	0.28	18	0.14	0.14
YKPK1012-183K-□□	18000	80	79.6KHz	0.26	25	0.13	0.12
YKPK1012-223K-□□	22000	80	79.6KHz	0.22	30	0.12	0.11
YKPK1012-273K-□□	27000	80	79.6KHz	0.20	35	0.11	0.10
YKPK1012-333K-□□	33000	60	79.6KHz	0.19	40	0.10	0.090
YKPK1012-393K-□□	39000	60	79.6KHz	0.17	50	0.090	0.080
YKPK1012-473K-□□	47000	60	79.6KHz	0.15	50	0.080	0.075
YKPK1012-563K-□□	56000	40	79.6KHz	0.13	65	0.075	0.070
YKPK1012-683K-□□	68000	40	79.6KHz	0.12	70	0.070	0.065
YKPK1012-823K-□□	82000	30	79.6KHz	0.10	100	0.060	0.055
YKPK1012-104K-□□	100000	30	79.6KHz	0.10	135	0.055	0.045

**YKPK1018Series**

Part No.	L@1KHz(uH)	DCR(Ohm)Max	Rated current (A)Max	
			I Sat	I rms
YKPK1018-4R7K-□□	4.7	0.008	10.0	6.0
YKPK1018-6R8K-□□	6.8	0.011	8.0	5.5
YKPK1018-100K-□□	10	0.017	7.0	4.5
YKPK1018-150K-□□	15	0.022	5.5	4.0
YKPK1018-220K-□□	22	0.026	4.5	3.7
YKPK1018-330K-□□	33	0.032	3.8	3.3
YKPK1018-470K-□□	47	0.035	3.2	3.0
YKPK1018-680K-□□	68	0.047	2.6	2.6
YKPK1018-101K-□□	100	0.090	2.2	2.0
YKPK1018-151K-□□	150	0.0129	1.8	1.6
YKPK1018-221K-□□	220	0.162	1.5	1.5
YKPK1018-331K-□□	330	0.212	1.2	1.2
YKPK1018-471K-□□	470	0.380	1.00	1.0
YKPK1018-681K-□□	680	0.548	0.84	0.84
YKPK1018-102K-□□	1000	0.844	0.66	0.66
YKPK1018-152K-□□	1500	1.18	0.55	0.55
YKPK1018-222K-□□	2200	2.00	0.46	0.44
YKPK1018-332K-□□	3300	2.53	0.38	0.38



YKPK1018-472K-□□	4700	3.19	0.32	0.32
YKPK1018-682K-□□	6800	5.69	0.26	0.25
YKPK1018-103K-□□	10000	7.30	0.22	0.22
YKPK1018-153K-□□	15000	10.5	0.18	0.18
YKPK1018-223K-□□	22000	21.8	0.14	0.13
YKPK1018-333K-□□	33000	25.7	0.12	0.12
YKPK1018-473K-□□	47000	36.1	0.10	0.10
YKPK1018-683K-□□	68000	57.3	0.08	0.08
YKPK1018-104K-□□	100000	89.7	0.06	0.06

**YKPK1213 Series**

Part No.	L@1KHz(μH)	DCR(Ohm)Max	Rated current (A)Max	
			I Sat	I rms
YKPK1213-100M-□□	10	0.023	8.0	5.1
YKPK1213-150K-□□	15	0.028	6.5	4.5
YKPK1213-220K-□□	22	0.035	5.5	4.2
YKPK1213-330K-□□	33	0.043	4.5	3.7
YKPK1213-470K-□□	47	0.052	3.6	3.4
YKPK1213-680K-□□	68	0.068	3.1	3.0
YKPK1213-101K-□□	100	0.097	2.6	2.5
YKPK1213-151K-□□	150	0.14	2.1	2.1
YKPK1213-221K-□□	220	0.20	1.7	1.7
YKPK1213-331K-□□	330	0.30	1.4	1.4
YKPK1213-471K-□□	470	0.43	1.10	1.1
YKPK1213-681K-□□	680	0.61	0.95	0.99
YKPK1213-102K-□□	1000	1.00	0.78	0.78
YKPK1213-152K-□□	1500	1.30	0.64	0.68
YKPK1213-222K-□□	2200	2.00	0.53	0.55
YKPK1213-332K-□□	3300	3.10	0.43	0.44
YKPK1213-472K-□□	4700	4.40	0.36	0.37
YKPK1213-682K-□□	6800	6.50	0.30	0.30
YKPK1213-103K-□□	10000	10.0	0.24	0.24